

**Approval Condition :**  
 This Plan Sanction is issued subject to the following conditions :  
 1. Sanction is accorded for the Residential Building at 10 & 11, #10 & 11 KENCHENAHALLI Bangalore.  
 2. Consist of 1stilt + 1Ground + 2 only.  
 3. Sanction is accorded for Residential use only. The use of the building shall not be deviated to any other use.  
 4. 350.30 area reserved for car parking shall not be converted for any other purpose.  
 5. The debris shall be removed and transported to near by dumping yard.  
 6. The applicant shall maintain during construction such barricading as considered necessary to prevent dust, debris & other materials endangering the safety of people / structures etc. in & around the site.  
 7. Necessary ducts for running telephone cables, cubicles at ground level for postal services & space for dumping garbage within the premises shall be provided.  
 8. The applicant shall INSURE all workmen involved in the construction work against any accident / untoward incidents arising during the time of construction.  
 9. The applicant shall not stock any building materials / debris on footpath or on roads or on drains.  
 10. The debris shall be removed and transported to near by dumping yard.  
 11. Permission shall be obtained from forest department for cutting trees before the commencement of the work.  
 12. License and approved plans shall be posted in a conspicuous place of the licensed premises. The building license and the copies of sanctioned plans with specifications shall be mounted on a frame and displayed and they shall be made available during inspections.  
 13. If any owner / builder contravenes the provisions of Building Bye-laws and rules in force, the Architect / Engineer / Supervisor will be informed by the Authority in the first instance, warned in the second instance and cancel the registration if the same is repeated for the third time.  
 14. Technical personnel, applicant or owner as the case may be shall strictly adhere to the duties and responsibilities specified in Schedule - IV (Bye-law No. 3.6) under sub section IV-9 (g) to (k).  
 15. The building shall be constructed under the supervision of a registered structural engineer.  
 16. On completion of foundation or footings before erection of walls on the foundation and in the case of columnar structure before erecting the columns "COMMENCEMENT CERTIFICATE" shall be obtained.  
 17. Drinking water supplied by BWSSB should not be used for the construction activity of the building.  
 18. The applicant shall ensure that the Rain Water Harvesting Structures are provided & maintained in good repair for storage of water for non potable purposes or recharge of ground water at all times having a minimum total capacity mentioned in the Bye-law 32(a).  
 19. If any owner / builder contravenes the provisions of Building Bye-laws and rules in force, the authority will inform the same to the concerned registered Architect / Engineers / Supervisor in the first instance, warn in the second instance and cancel the registration of the professional if the same is repeated for the third time.  
 20. The Builder / Contractor / Professional responsible for supervision of work shall not shall materially and structurally deviate the construction from the sanctioned plan, without previous approval of the authority. They shall explain to the owner s about the risk involved in contravention of the provisions of the Act, Rules, Bye-laws, Zoning Regulations, Standing Orders and Policy Orders of the BBMP.  
 21. In case of any false information, misrepresentation of facts, or pending court cases, the plan sanction is deemed cancelled.

COLOR INDEX	
PLOT BOUNDARY	Black
ABUTTING ROAD	Red
PROPOSED WORK (COVERAGE AREA)	Green
EXISTING (To be retained)	Blue
EXISTING (To be demolished)	Yellow

AREA STATEMENT (BBMP)		VERSION NO. : 1.0.9
PROJECT DETAIL:		VERSION DATE: 01/11/2018
Authority: BBMP	Plot Use: Residential	
BBMP/Ad.Com./R.H/0089/19-20	Plot SubUse: Plotted Resi development	
Application Type: Savarna Parvangi	Land Use Zone: Residential (Main)	
Proposal Type: Building Permission	Plot/Sub Plot No.: 10 & 11	
Nature of Sanction: New	Khata No. (As per Khata Extract): 2043/10,11/10/22	
Location: Ring-III	Locality / Street of the property: #10 & 11 KENCHENAHALLI	
AREA DETAILS:		SQ.MT.
AREA OF PLOT (Minimum)	(A)	101.51
NET AREA OF PLOT	(A-Deductions)	101.51
COVERAGE CHECK:		
Permissible Coverage area (75.00 %)		76.13
Proposed Coverage Area (61.19 %)		62.11
Achieved Net coverage area ( 61.19 % )		62.11
Balance coverage area left ( 13.81 % )		14.02
FAR CHECK:		
Permissible F.A.R. as per zoning regulation 2015 ( 1.75 )		177.64
Additional F.A.R. within Ring I and II ( for amalgamated plot - )		0.00
Allowable TDR Area (60% of Perm.FAR )		0.00
Allowable max. F.A.R. Plot within 150 Mt radius of Metro station ( - )		0.00
Total Perm. FAR area ( 1.75 )		177.64
Residential FAR Area (63.34% )		165.55
Proposed FAR Area		177.37
Achieved Net FAR Area ( 1.75 )		177.37
Balance FAR Area ( 0.00 )		0.27
BUILT UP AREA CHECK:		
Proposed BuiltUp Area		243.55
Achieved BuiltUp Area		243.55

Approval Date : 05/10/2019 6:01:33 PM

**Payment Details**

Sr No.	Challan Number	Receipt Number	Amount (NR)	Payment Mode	Transaction Number	Payment Date	Remark
1	BBMP/0686/CH/19-20	BBMP/0686/CH/19-20	743	Online	8353134913	04/24/2019 2:21:59 PM	-
	No.		Head		Amount (NR)	Remark	
	1		Scrutiny Fee		743	-	

**Block USE/SUBUSE Details**

Block Name	Block Use	Block SubUse	Block Structure	Block Land Use Category
A (A)	Residential	Plotted Resi development	Bldg upto 11.5 mt. Ht.	R

**Required Parking (Table 7a)**

Block Name	Type	SubUse	Area (Sq.mt.)	Reqd.	Prop.	Reqd./Unit	Car Reqd.	Prop.
A (A)	Residential	Plotted Resi development	50 - 225	1	-	1	2	-
Total :				-	-	-	2	2

**Parking Check (Table 7b)**

Vehicle Type	Reqd.		Achieved	
	No.	Area (Sq.mt.)	No.	Area (Sq.mt.)
Car	2	27.50	2	27.50
Total Car	2	27.50	2	27.50
TwoWheeler	-	13.75	0	0.00
Other Parking	-	-	-	22.80
Total		41.25		50.30

**FAR & Tenement Details**

Block	No. of Same Bldg	Total Built Up Area (Sq.mt.)	Deductions (Area in Sq.mt.)		Proposed FAR Area (Sq.mt.)	Total FAR Area (Sq.mt.)	Trmt (No.)
			Stair/Case	Parking			
A (A)	1	243.55	15.90	50.30	165.54	177.35	02
Grand Total:	1	243.55	15.90	50.30	165.54	177.35	2.00

**Block :A (A)**

Floor Name	Total Built Up Area (Sq.mt.)	Deductions (Area in Sq.mt.)		Proposed FAR Area (Sq.mt.)	Total FAR Area (Sq.mt.)	Trmt (No.)
		Stair/Case	Parking			
Terrace Floor	15.90	15.90	0.00	0.00	0.00	00
Second Floor	41.32	0.00	0.00	41.32	41.32	00
First Floor	62.11	0.00	0.00	62.11	62.11	01
Ground Floor	62.11	0.00	0.00	62.11	62.11	01
Stilt Floor	62.11	0.00	50.30	0.00	11.81	00
Total:	243.55	15.90	50.30	165.54	177.35	02
Total Number of Same Blocks	1					
Total:	243.55	15.90	50.30	165.54	177.35	02

**SCHEDULE OF JOINERY:**

BLOCK NAME	NAME	LENGTH	HEIGHT	NOS
A (A)	D1	0.76	2.10	05
A (A)	D	0.91	2.10	09

**SCHEDULE OF JOINERY:**

BLOCK NAME	NAME	LENGTH	HEIGHT	NOS
A (A)	W	1.52	2.00	23

**UnitBUA Table for Block :A (A)**

FLOOR	Name	UnitBUA Type	UnitBUA Area	Carpet Area	No. of Rooms	No. of Tenement
GROUND FLOOR PLAN	1	FLAT	62.11	55.06	5	1
SECOND FLOOR PLAN	SPLIT 1	FLAT	0.00	0.00	3	0
FIRST FLOOR PLAN	SPLIT 1	FLAT	103.44	89.34	5	1
Total:	-	-	165.55	144.40	13	2

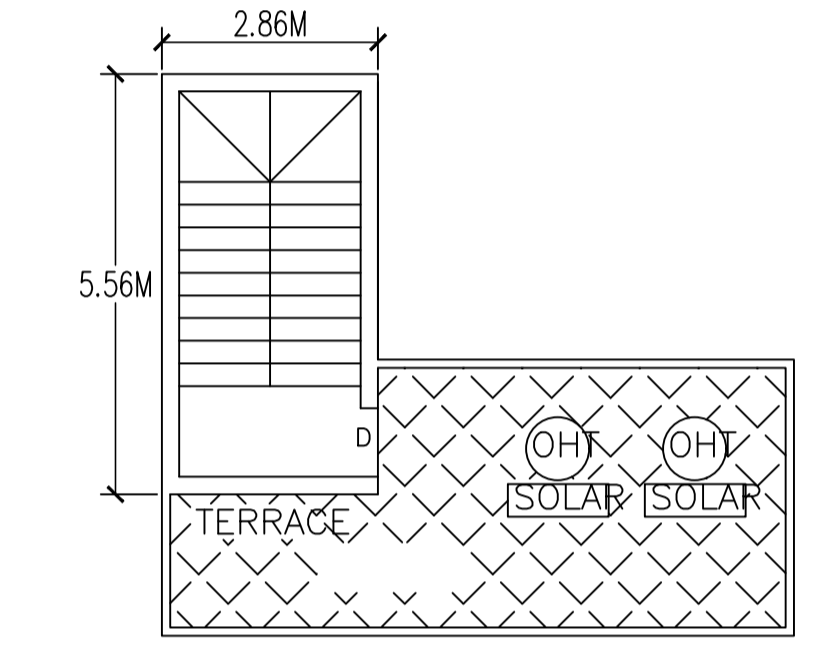
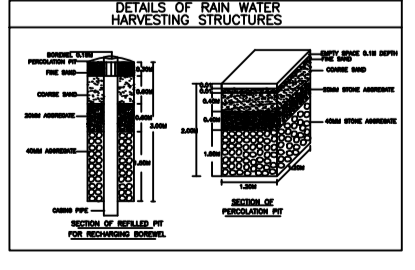

PROPOSED TERRACE FLOOR PLAN

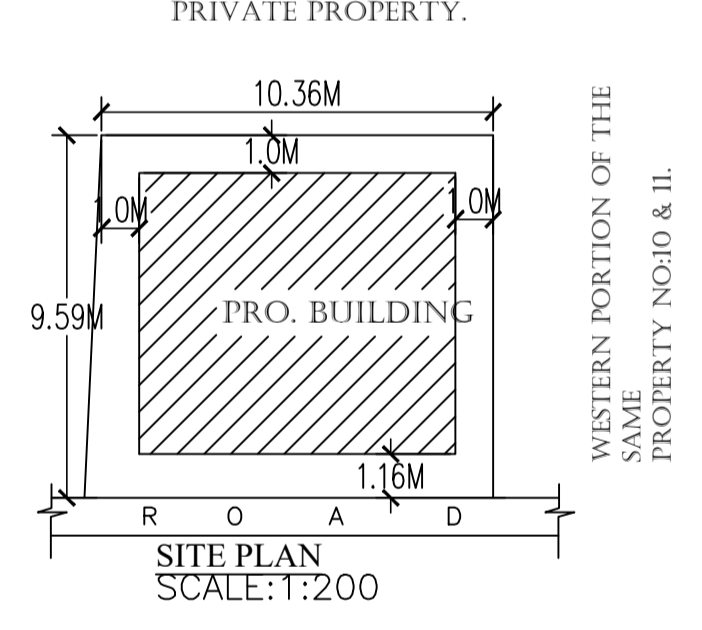

SITE PLAN SCALE: 1:200

The plans are approved in accordance with the acceptance for approval by the Assistant Director of town planning (RR\_NAGAR) on date: 10/05/2019. Provide Ip number: BBMP/Ad.Com./R.H/0089/19-20 subject to terms and conditions laid down along with this building plan approval. Validity of this approval is two years from the date of issue.

ASSISTANT DIRECTOR OF TOWN PLANNING (RR\_NAGAR)  
 BHRUHAT BENGALURU MAHANAGARA PALIKE

OWNER / GPA HOLDER'S SIGNATURE  
 OWNER'S ADDRESS WITH ID NUMBER & CONTACT NUMBER :  
 YOGANANDA  
 #33, 1ST MAIN, NEAR MYSORE ROAD, PUBLIC SCHOOL PIPE LINE WEST ROAD, KASTHURIBA NAGAR BANGALORE-560026  
 AADHAAR NO.4257 3653 5753.

ARCHITECT/ENGINEER /SUPERVISOR 'S SIGNATURE  
 SUSHMITHA S #307, 2nd stage, 6th block, nagarabhavi BCC/BL-3.6/4335/2018-19

*Sushmitha S*